

**NOTES:**

- EXISTING UTILITIES, STRUCTURES, TOPOGRAPHIC AND PROPERTY LINE INFORMATION SHOWN HEREON IS TAKEN FROM THE "PROPERTY AND TOPOGRAPHIC SURVEY" DEPICTING 230 EAST AVENUE & 10 ROWAN STREET PREPARED BY REMISS & MEAD OF STAMFORD, CT, DATED SEPTEMBER 15, 2017.
- LOCATIONS OF EXISTING UNDERGROUND STRUCTURES AND UTILITIES INDICATED HEREON ARE TAKEN FROM DESIGN DRAWINGS, FIELD OBSERVATIONS, AND OTHER SOURCES OF INFORMATION AND ARE NOT TO BE CONSIDERED AS AN ACCURATE "AS-BUILT" SURVEY. THE CONTRACTOR SHALL EXCAVATE TEST HOLES, CONTACT "CALL BEFORE YOU DIG", AND PERFORM WHATEVER ADDITIONAL VERIFICATION NECESSARY TO VERIFY THE EXISTING INFORMATION. THE PROJECT ENGINEER SHALL BE PROMPTLY NOTIFIED OF ANY APPARENT CONFLICTS BETWEEN EXISTING UTILITIES AND PROPOSED WORK.
- THE PURPOSE OF THIS PLAN IS TO INDICATE THE PROPOSED SITE UTILITIES REQUIRED FOR RENOVATION OF THE EXISTING BUILDING "A" AND CONSTRUCTION OF NEW BUILDINGS "B" AND "C".
- ALL CONSTRUCTION SHALL CONFORM TO THE CITY OF NORWALK STANDARD DETAILS AND SPECIFICATIONS, IN THE ABSENCE OF LOCAL STANDARDS, THE WORK SHALL CONFORM TO THE REQUIREMENTS OF THE CONNECTICUT DEPARTMENT OF TRANSPORTATION SPECIFICATION FORM 817, LATEST REVISION.
- ALL WORK WITHIN THE STREET RIGHT-OF-WAY SHALL BE COORDINATED WITH THE CITY OF NORWALK DEPARTMENT OF PUBLIC WORKS.
- ALL UTILITY CONNECTIONS SHALL BE COORDINATED WITH THEIR RESPECTIVE UTILITY PROVIDER.
- THE CONTRACTOR IS RESPONSIBLE FOR OBTAINING ALL NECESSARY PERMITS PRIOR TO THE COMMENCEMENT OF THE WORK.

**LEGEND**

EXISTING	ITEM	PROPOSED
	CATCH BASIN	
	MANHOLE	
	DRAIN	
	SANITARY SEWER	
	STORM SEWER	
	WATER SERVICE	
	CONTOUR	
	SPOT ELEVATION	
	SILT FENCE	
	TREE TO REMAIN	N.A.
	POLE	N.A.

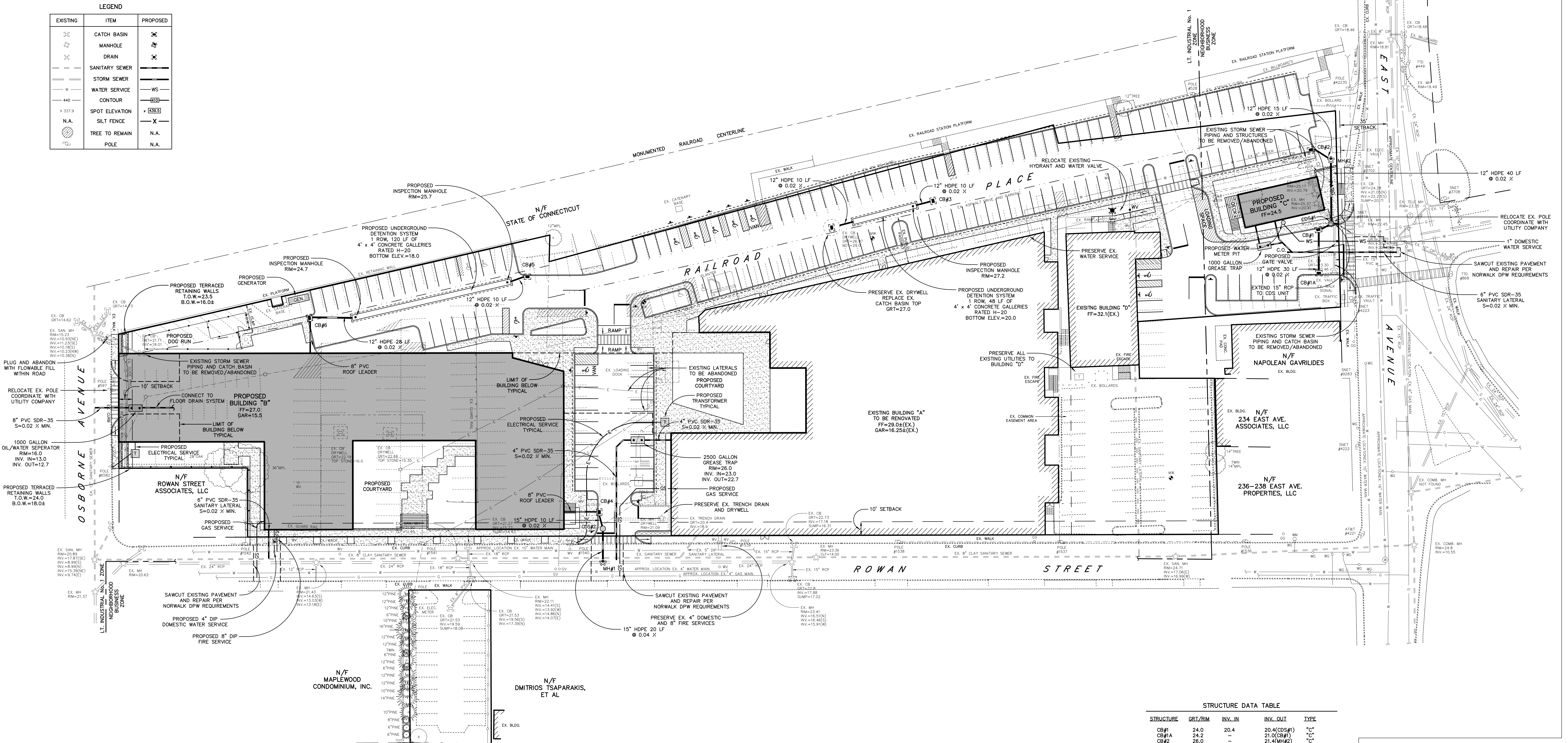
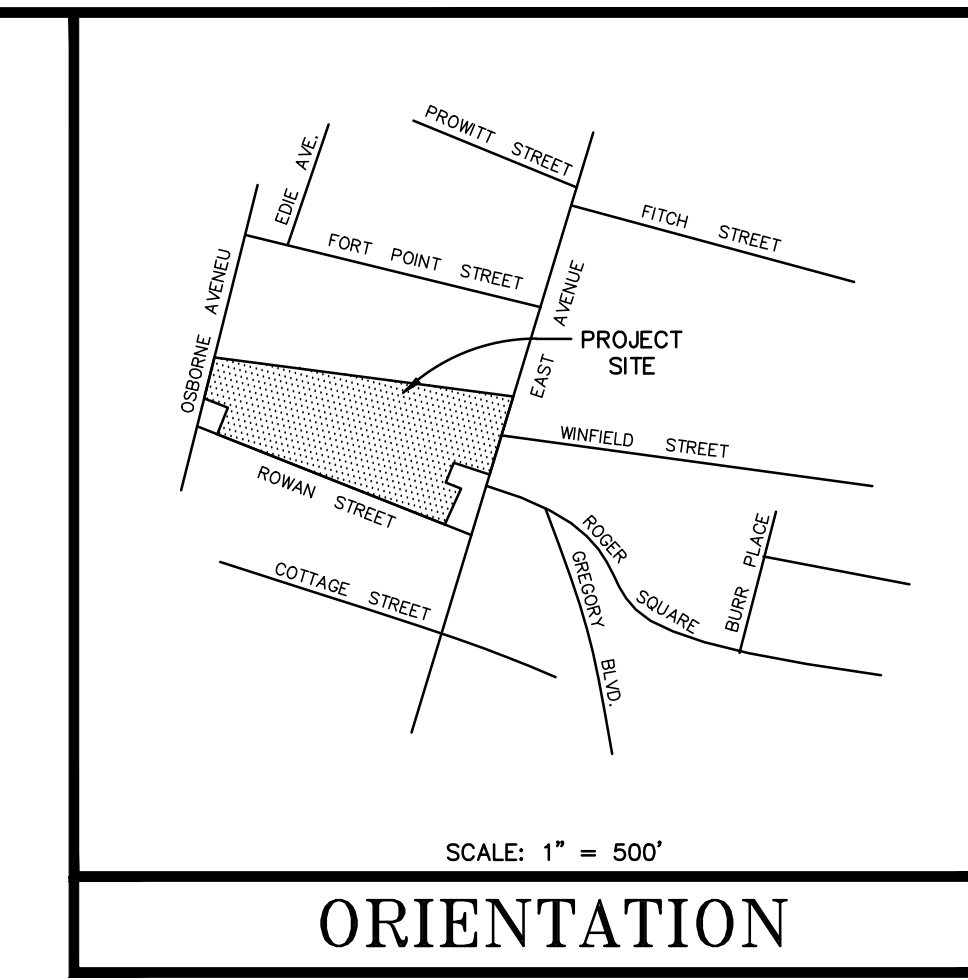

**STRUCTURE DATA TABLE**

STRUCTURE	GRIT/RIM	INV. IN	INV. OUT	TYPE
CB#1	24.0	20.4	20.4(CDS#1)	"C"
CB#1A	24.2	-	21.0(CB#1)	"C"
CB#2	26.0	-	21.4(MH#2)	"C"
CB#3	27.0	-	23.8(DET)	"C-L"
CB#4	23.0	19.4(ROOF)	18.8(CDS#2)	"C"
CB#5	26.0	-	22.8(DET)	"C"
CB#6	24.0	21.5(ROOF)	21.2(DET)	"C"
MH#1	23.0	17.8(CB#4)	14.8#(EX)	DOG HOUSE
MH#2	24.0	14.9#(EX)	21.0(CDS#1)	MANHOLE
CDS#1	24.1	20.2(CB#1)	2021(EX. MH)	CDS 2015-4
CDS#2	22.9	18.6(CB#5)	18.6(MH#1)	CDS 2015-4

NO.	DATE	REVISIONS AND SUBMISSIONS
2	2-14-18	REVISED AND ISSUED TO P&Z
1	12-14-17	ISSUED TO P&Z

**McChord Engineering Associates, Inc.**  
Civil Engineers and Land Planners  
1 Grumman Hill Road  
Wilton, CT 06897 (203) 834-0569

PLAN PREPARED FOR  
230 EAST AVENUE, LLC  
NORWALK, CONNECTICUT

SITE UTILITY PLAN  
230 EAST AVENUE  
NORWALK, CONNECTICUT

JOB NO: 2028A-1 DATE: DECEMBER 14, 2017  
DRAWN BY: DRS CHECKED BY: HWM, TSN  
SCALE: 1" = 30'

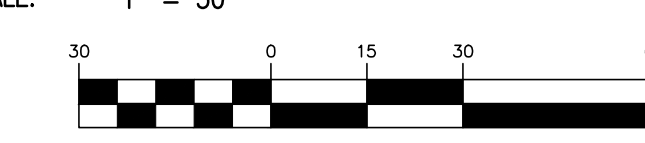

SE2