

GENERAL NOTES:

- EXISTING UTILITIES, TOPOGRAPHY AND PROPERTY LINE INFORMATION SHOWN ON THIS PLAN IS TAKEN FROM EXISTING RECORDS AND FIELD SURVEY PERFORMED BY RYAN AND FAULDS LAND SURVEYORS.
- LOCATIONS OF EXISTING UNDERGROUND STRUCTURES AND UTILITIES INDICATED HEREON ARE TAKEN FROM DESIGN DRAWINGS, FIELD OBSERVATIONS, AND OTHER SOURCES OF INFORMATION AND ARE NOT TO BE CONSTRUED AS AN ACCURATE "AS-BUILT" SURVEY. THE CONTRACTOR IS RESPONSIBLE FOR HAVING THE EXISTING UTILITIES MARKED OUT IN THE FIELD, EXCAVATE TEST HOLES, AND PERFORM WHATEVER ADDITIONAL INVESTIGATION IS REQUIRED TO PRESERVE THE INTEGRITY AND OPERATION OF EXISTING UTILITIES AND STRUCTURES TO REMAIN.
- THE PURPOSE OF THIS PLAN IS TO INDICATE THE PROPOSED SITE GRADING AND SOIL EROSION CONTROLS AS REQUIRED FOR THE PROPOSED BUILDING AND SITE IMPROVEMENTS.
- ALL CONSTRUCTION SHALL CONFORM TO THE CITY OF NORWALK STANDARD DETAILS AND SPECIFICATIONS, IN THE ABSENCE OF LOCAL STANDARDS, THE WORK SHALL CONFORM TO THE REQUIREMENTS OF THE CONNECTICUT DEPARTMENT OF TRANSPORTATION SPECIFICATION FORM B17, LATEST REVISION.
- A 4" LAYER OF TOPSOIL SHALL BE SPREAD OVER ALL LAWN, LANDSCAPE AND SLOPE AREAS. FINAL SEEDING OF DISTURBED AREAS SHALL BE COMPLETED AS SOON AS PRACTICABLE AND COVERED WITH HAY TO PREVENT EROSION DURING THE GERMINATION PERIOD.
- ALL EROSION AND SEDIMENT CONTROL MEASURES WILL BE INSTALLED PRIOR TO CONSTRUCTION WHENEVER POSSIBLE.
- THE CONTRACTOR IS RESPONSIBLE FOR OBTAINING ALL NECESSARY PERMITS PRIOR TO THE COMMENCEMENT OF THE WORK.

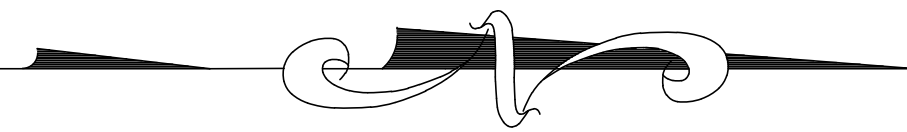

ET AL

LEGEND		
EXISTING	ITEM	PROPOSED
	CATCH BASIN	
	MANHOLE	
	DRAIN	
	SANITARY SEWER	
	STORM SEWER	
	WATER SERVICE	
	CONTOUR	
	SPOT ELEVATION	
	SILT FENCE	
	TREE TO REMAIN	N.A.
	POLE	N.A.

Scale: 1" = 20'

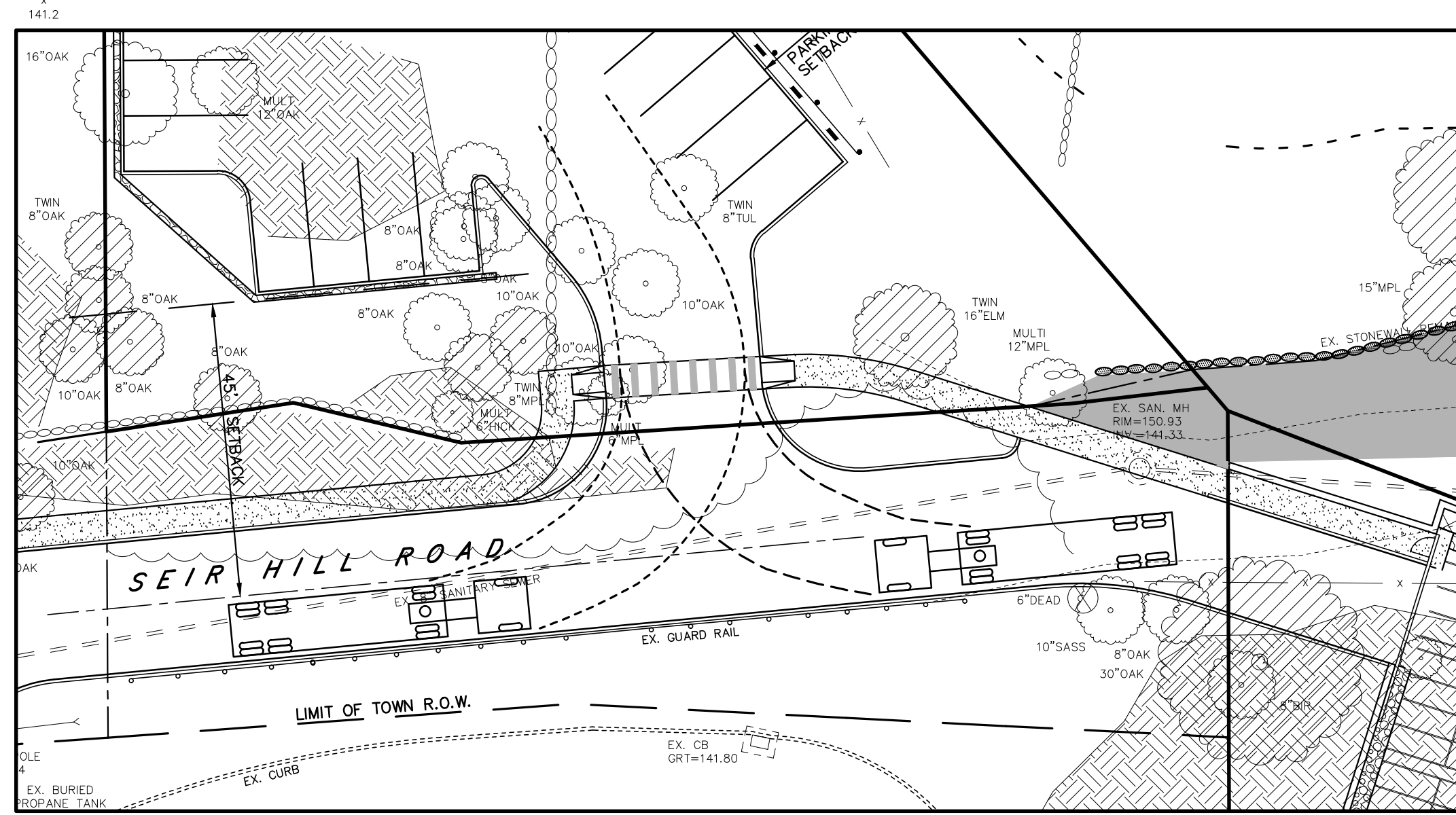
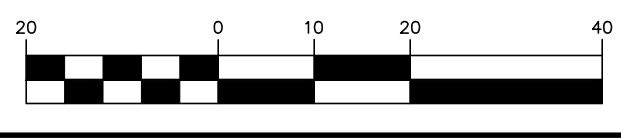

WB-40 TRUCK TURNING
SCALE: 1" = 20'

HMTX World Headquarters

Stone Realty & Associates, LLC
15 Oakwood Avenue
Norwalk, CT 06850

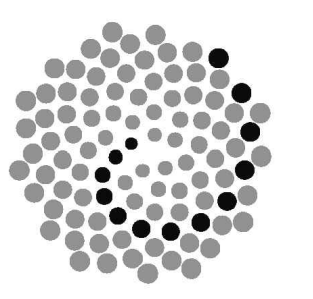

McLennan Design, LLC
175 Parfitt Way SW, Suite N160
Bainbridge Island, WA 98101
t 206 219 3777

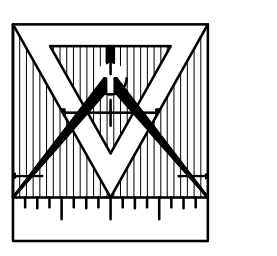

McChord Engineering Associates, Inc.
1 Grumman Hill Road
Wilton, CT 06897
t 203 834 0569

Professional Seals

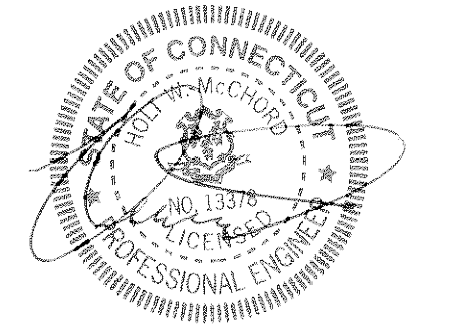

No.	Issue Description	YYYY-MM-DD
1	ISSUED TO P&Z	2018-01-11
2	REMOVED FUTURE SEIR HILL ROAD CONNECTION	2018-01-18
3	REVISED AND ISSUED TO P&Z	2018-01-25
4	REVISED AND ISSUED TO P&Z	2018-02-16
5	REVISED AND ISSUED TO P&Z	2018-03-07
6	REVISED AND ISSUED TO P&Z	2020-06-05

No.	Revision Description	YYYY-MM-DD

Drawn by DRS Reviewed by HWM

Project No. 16033

All reproduction & intellectual property rights reserved © 2015

Sheet Title:
SITE GRADING AND SOIL EROSION CONTROL PLAN OFF-SITE PARKING AREA

Original drawing is Arch D. Do not scale contents of this drawing.
Sheet Number:

C105