

NO.	ISSUE	DATE
9	UPDATED SITE PLAN	18.05.22
8	ZONING - REVISED	18.10.16
7	PEER REVIEW COMMENTS - REVISED	18.10.05
6	CITY REVIEW COMMENTS - REVISED	18.10.04
5	PEER REVIEW COMMENTS - REVISED	18.09.26
4	PEER REVIEW COMMENTS - REVISED	18.09.26
3	ZONING COMMENTS - REVISED	18.09.17
2	ZONING - REVISED	18.08.30
1	ZONING	18.07.24

NO.	ISSUE
9	UPDATED SITE PLAN
8	ZONING - REVISED
7	PEER REVIEW COMMENTS - REVISED
6	CITY REVIEW COMMENTS - REVISED
5	PEER REVIEW COMMENTS - REVISED
4	PEER REVIEW COMMENTS - REVISED
3	ZONING COMMENTS - REVISED
2	ZONING - REVISED
1	ZONING

#1 CHESTNUT ST.
 CHESTNUT AND MONROE STREETS
 NORWALK, CT

PROJECT
 DWG/TITLE
**LANDSCAPE
 SITE PLAN**

JOB NO.
 DATE
 2018.07.24
 SCALE
 AS NOTED

SPL-2.0

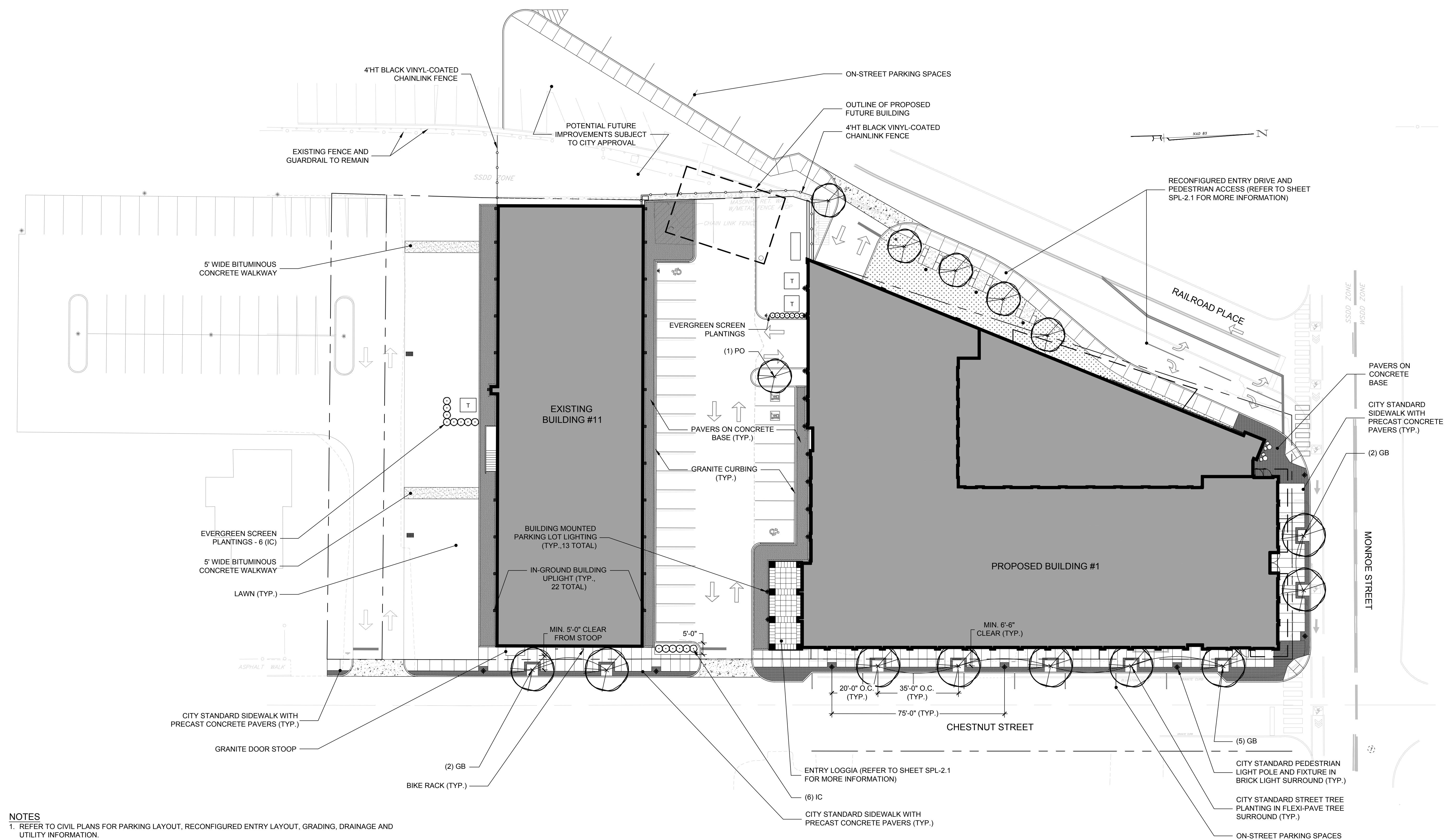

- NOTES**
- REFER TO CIVIL PLANS FOR PARKING LAYOUT, RECONFIGURED ENTRY LAYOUT, GRADING, DRAINAGE AND UTILITY INFORMATION.
 - REFER TO PHOTOMETRIC STUDIES FOR MORE INFORMATION ON SITE LIGHTING.
 - ALL SIDEWALK PAVEMENT(S), CURBING, TREE SURROUNDS AND LIGHT SURROUNDS SHALL BE CONSTRUCTED PER CITY OF NORWALK DPW STANDARD DETAILS, LATEST EDITION; REFER TO DETAIL SHEET SPL-3.0.

LUMINAIRE SCHEDULE

SYMBOL	QTY	FINISH	DESCRIPTION	OVERALL HT.
⊕	7	BLACK	VLL-LE080-X2-45-CR3-P11, TYPE III POST: VILLA PEDESTRIAN - 12' HT. POLE WITH GFI OUTLET. SUPPLIED BY: SPRING CITY ELECTRICAL. CONTACT: PAUL MELLOR (701) 245-0044	14'-11"

PLANTING SCHEDULE

SYM	QTY	BOTANICAL NAME	COMMON NAME	ROOT	MIN. SIZE	COMMENTS
TREES						
PO	1	Platanus occidentalis 'Bloodgood'	BLOODGOOD PLANE TREE	B&B	3" - 3-1/2" cal.	Full, 7' Clear Branching
GB	9	Ginkgo biloba 'Princeton Sentry'	PRINCETON SENTRY GINKO	B&B	3" - 3-1/2" cal.	Male Only, Full, Single Trunk - 7' Clear Branching
EVERGREEN SHRUBS						
IC	12	Ilex crenata 'Schwoebel'	SCHWOEBEL HOLLY	B&B	30" - 36"	Full, Heavy; Hedged