

SOIL & WETLAND SCIENCE, LLC

**OTTO R. THEALL
PROFESSIONAL SOIL SCIENTIST
PROFESSIONAL WETLAND SCIENTIST
2 LLOYD ROAD
NORWALK, CONNECTICUT 06850
OFFICE (203) 845-0278
CELL (203) 247-0650
EMAIL: soilwetlandsci@aol.com**

**SOIL INVESTIGATION REPORT
51 ½ NORTH BRIDGE STREET
NORWALK, CONNECTICUT
JUNE 7, 2019**

I conducted an on-site investigation of the soils on the vacant property that is located at 51 ½ North Bridge Street in Norwalk, Connecticut on June 7, 2019. The examination for inland wetland soils was conducted in the field by inspection of approximately 45 soil samples taken with spade and auger.

The definitions of wetlands and intermittent watercourses used are as follows. Inland wetlands in Connecticut are lands, including submerged lands, which consist of any of the soil types designated as poorly drained, very poorly drained, alluvial, and floodplain by the NCSS. Intermittent watercourses are to be delineated by a defined permanent channel and bank and the occurrence of two or more of the following characteristics: (A) evidence of scour or deposits of recent alluvium or detritus, (B) the presence of standing or flowing water for a duration longer than a particular storm incident, and (C) the presence of hydrophytic vegetation.

The wetland boundaries were marked in the field with pink flags numbered 1 through 12. The wetland contains a watercourse. The wetland soils consist of Ridgebury, Leicester and Whitman soils, extremely stony (3). The non-wetland soils consist of Sutton fine sandy loam, extremely stony (52) and Udorthents, smoothed (308). The soil map units contain inclusions of other soil types. The results of this investigation are subject to change until accepted by the Norwalk Inland Wetland Agency.

Respectfully submitted:

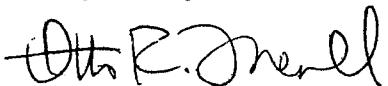

Otto R. Theall
Professional Soil Scientist

SKETCH OF SOIL SURVEY
 51 1/2 NORTH BRIDGE STREET
 NORWALK, CONNECTICUT
 SOIL & WETLAND SCIENCE, LLC
 OTTO R. THEALL
 PROFESSIONAL SOIL SCIENTIST
 JUNE 7, 2019

SOIL LEGEND:

Wetland Soils:

3 = Ridgebury, Leicester & Whitman

Non-wetland Soils:

52 = Sutton fine sandy loam, e. stony

308 = Udorthents, smoothed

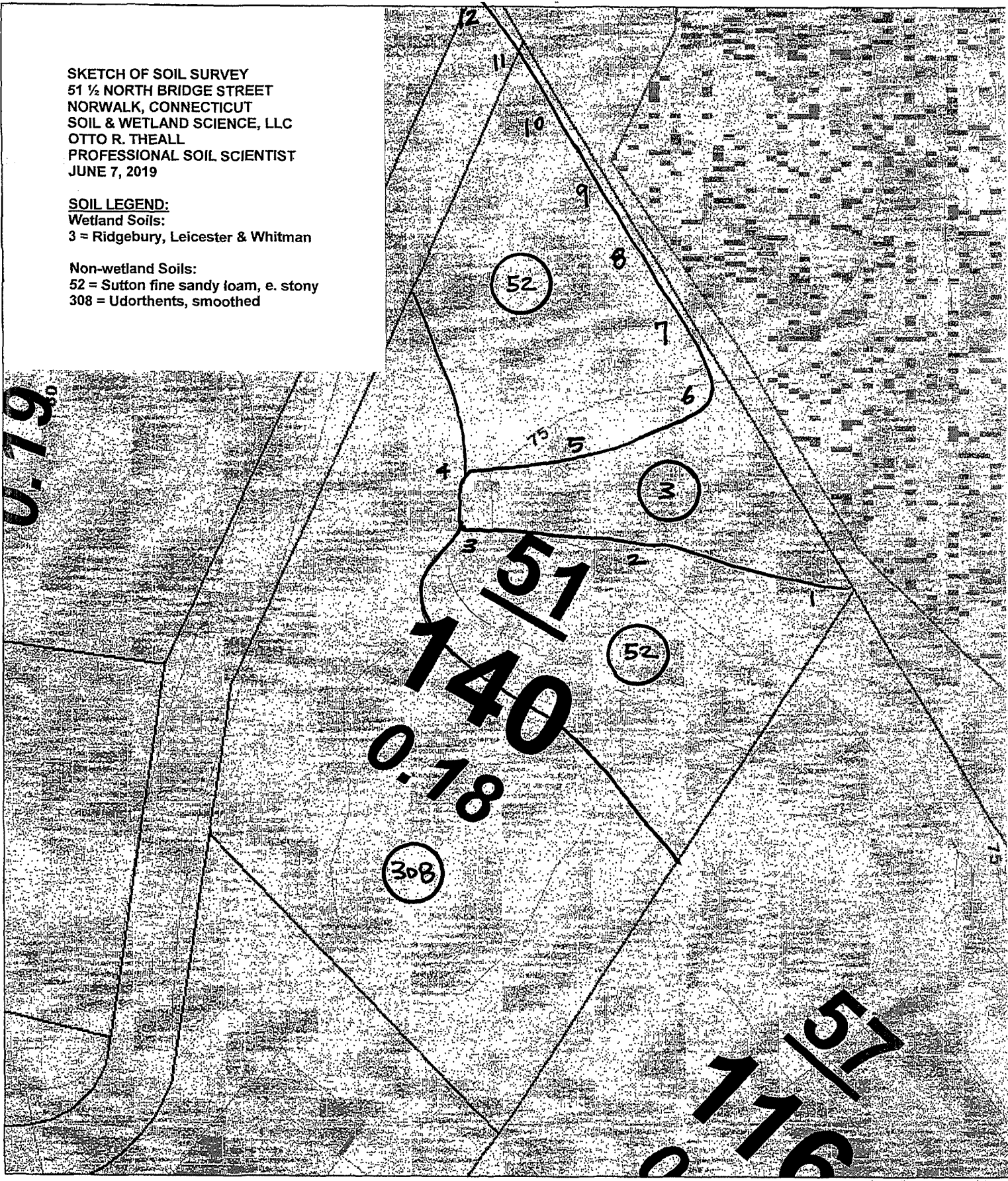

511/2 NORTH BRIDGE SREET NORWALK

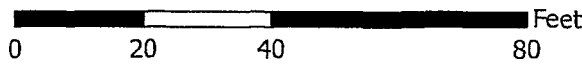
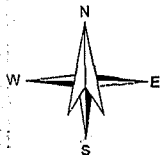

1 inch = 30 feet

